

Spool Type	Illustration	a1 (mm)	a2 (mm)	a3 (mm)	B1 (mm)	B2 (mm)	Net weight (max)
K50	1	50	32	11	50	37,5	ca. 0,5 kg
K80	1	80	50	16	80	64	ca. 1 kg
K100	1	100	63	16	100	80	ca. 2 kg
K125	1	125	80	16	125	100	ca. 3 kg
K160	1	160	100	22	160	128	ca. 6 kg
K200	1	200	125	22	200	160	ca. 10 kg
K250	1	250	160	22	200	160	ca. 18 kg
K355	1	355	224	36	200	160	ca. 30 kg
DWF 500	1	500	315	36	250	180	ca. 50 kg
SD 300 K	2	300	212	51,5	103	91	ca. 15 kg
SH 370/90 K	3	370	310	305	98	80	ca. 44 kg
SH 390 K	3	390	310	305	89	79	ca. 48 kg
SH 460 K	3	460	319	305	105	91	ca. 35 kg
BS 760 (Metal)	1	760	400	40	320	270	ca. 500 kg

Illustration 1

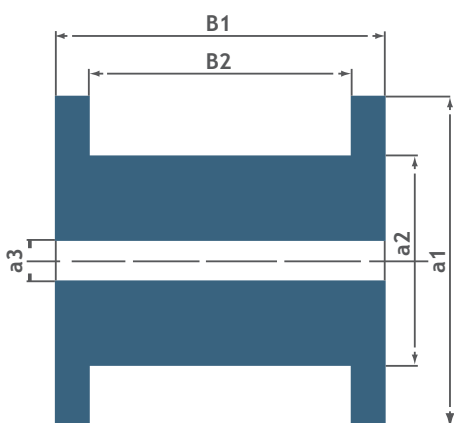

Illustration 2

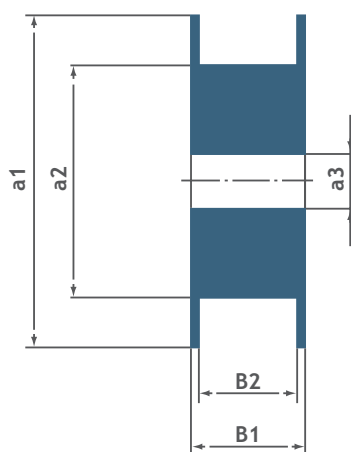

Illustration 3

